

10 2300 ACM @ Door Header - Tilt Up
6" = 1'-0"

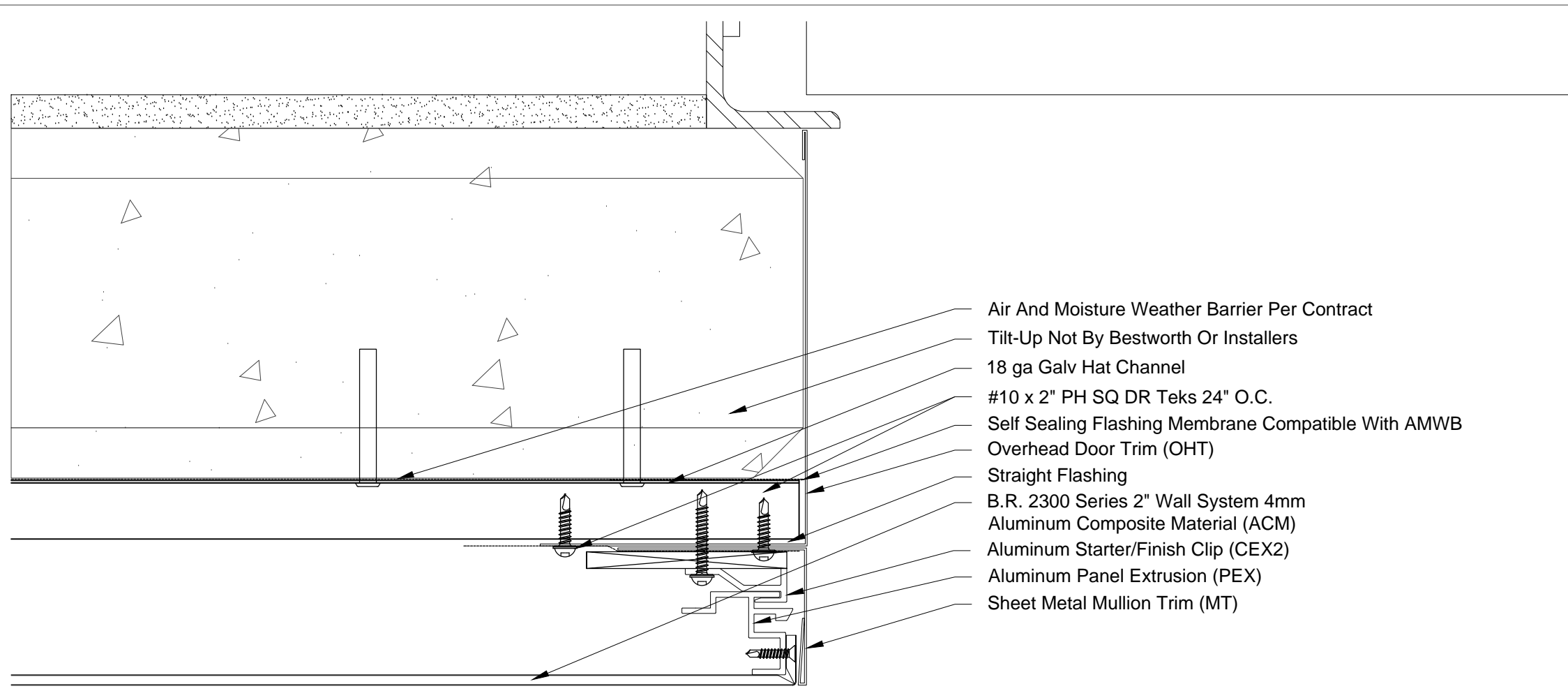

13 2300 ACM @ Overhead Door Jamb - Tilt Up
6" = 1'-0"

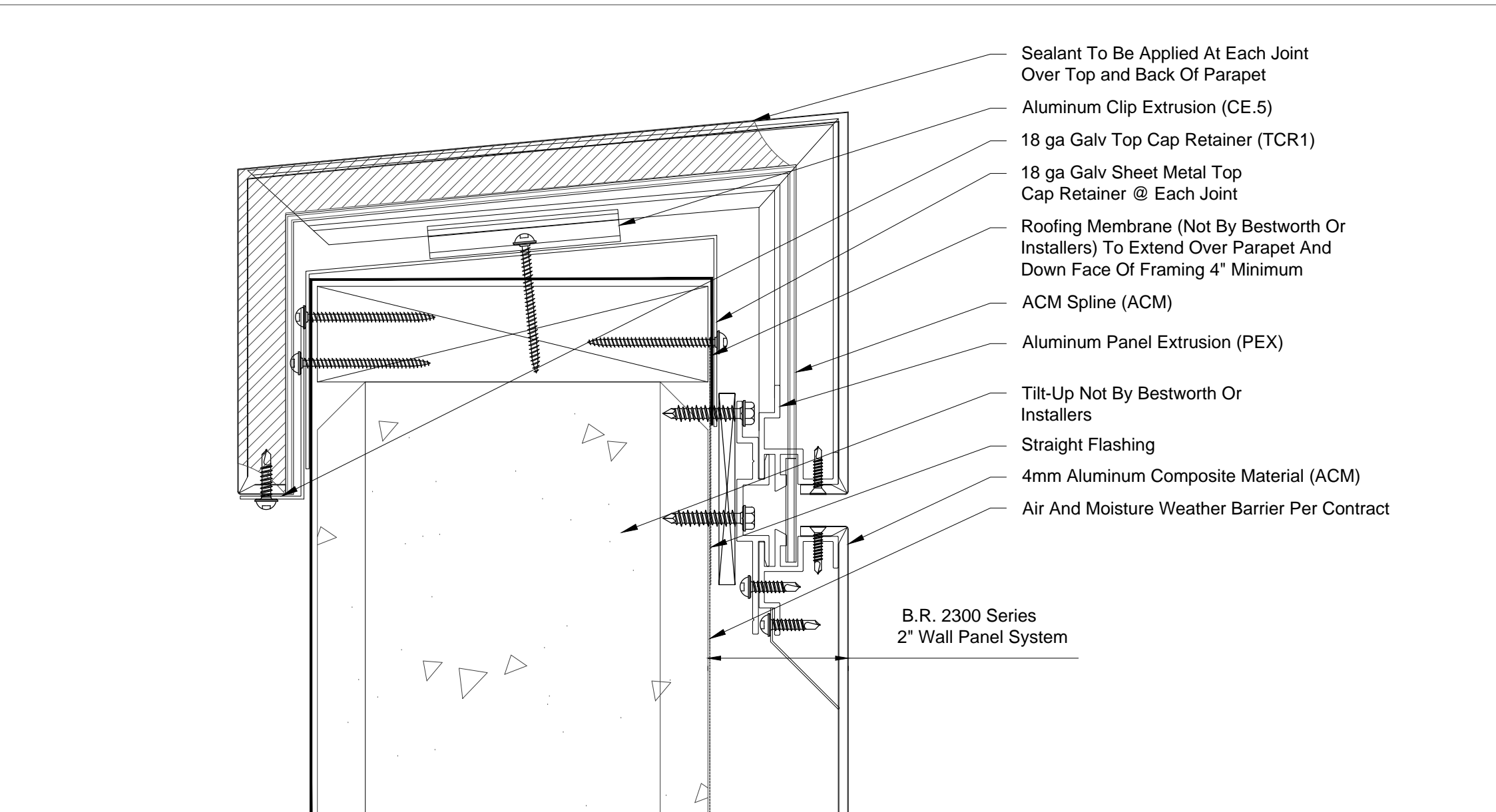

16 2300 ACM @ ACM Top Cap - Tilt Up
6" = 1'-0"

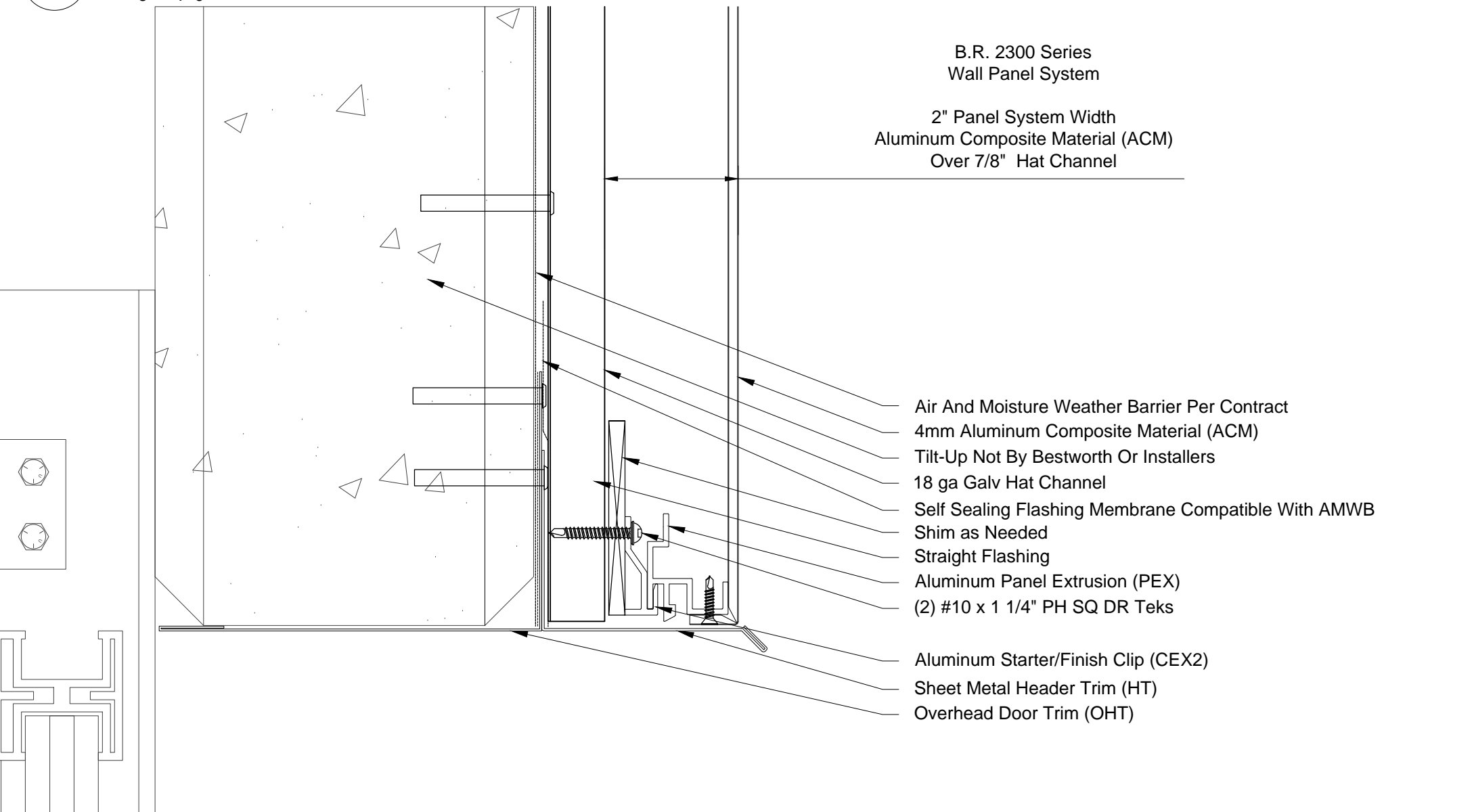

11 2300 ACM @ Overhead Door Header - Tilt Up
6" = 1'-0"

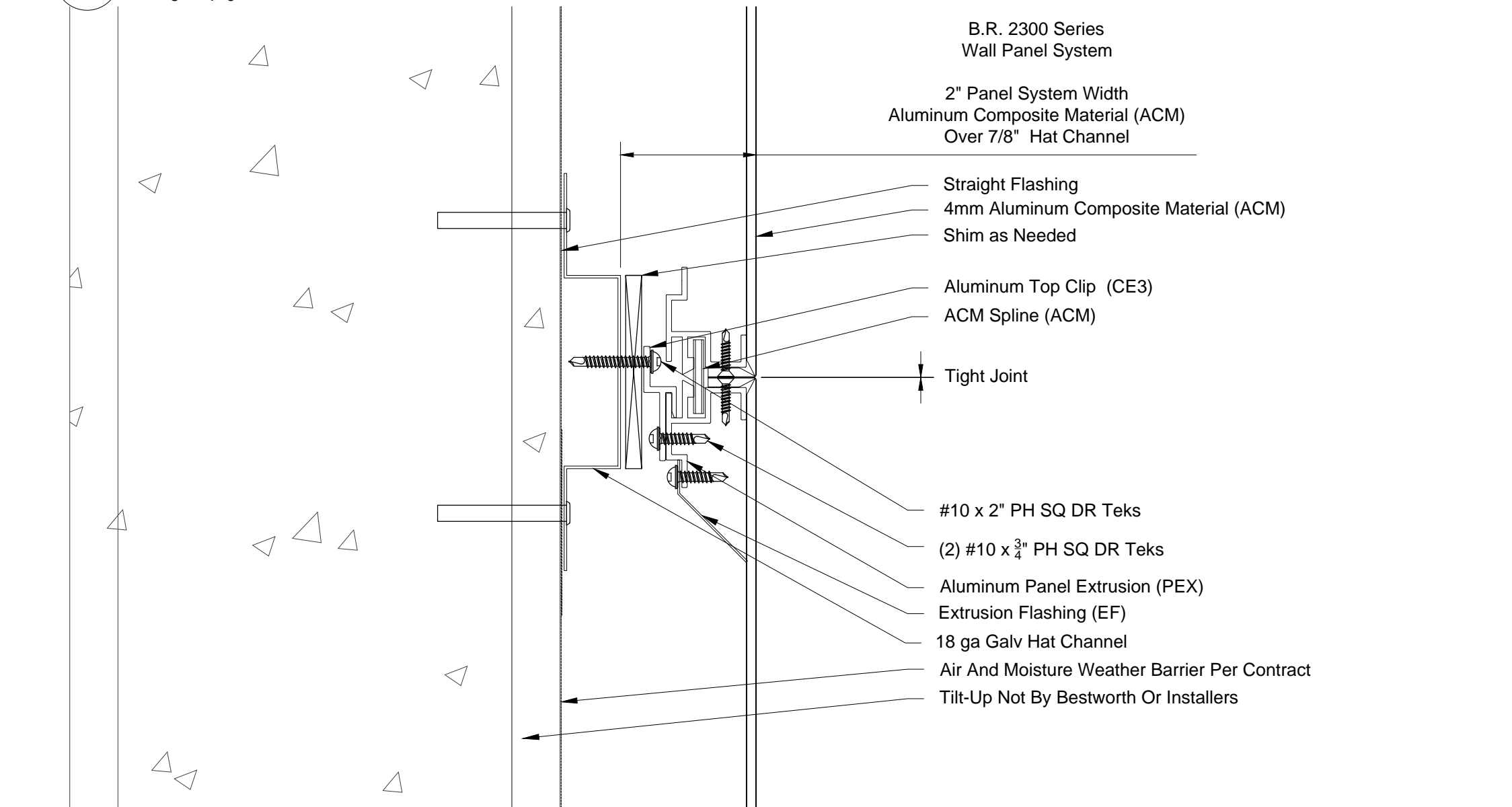

14 2300 ACM @ Tight Panel Joint - Tilt Up
6" = 1'-0"

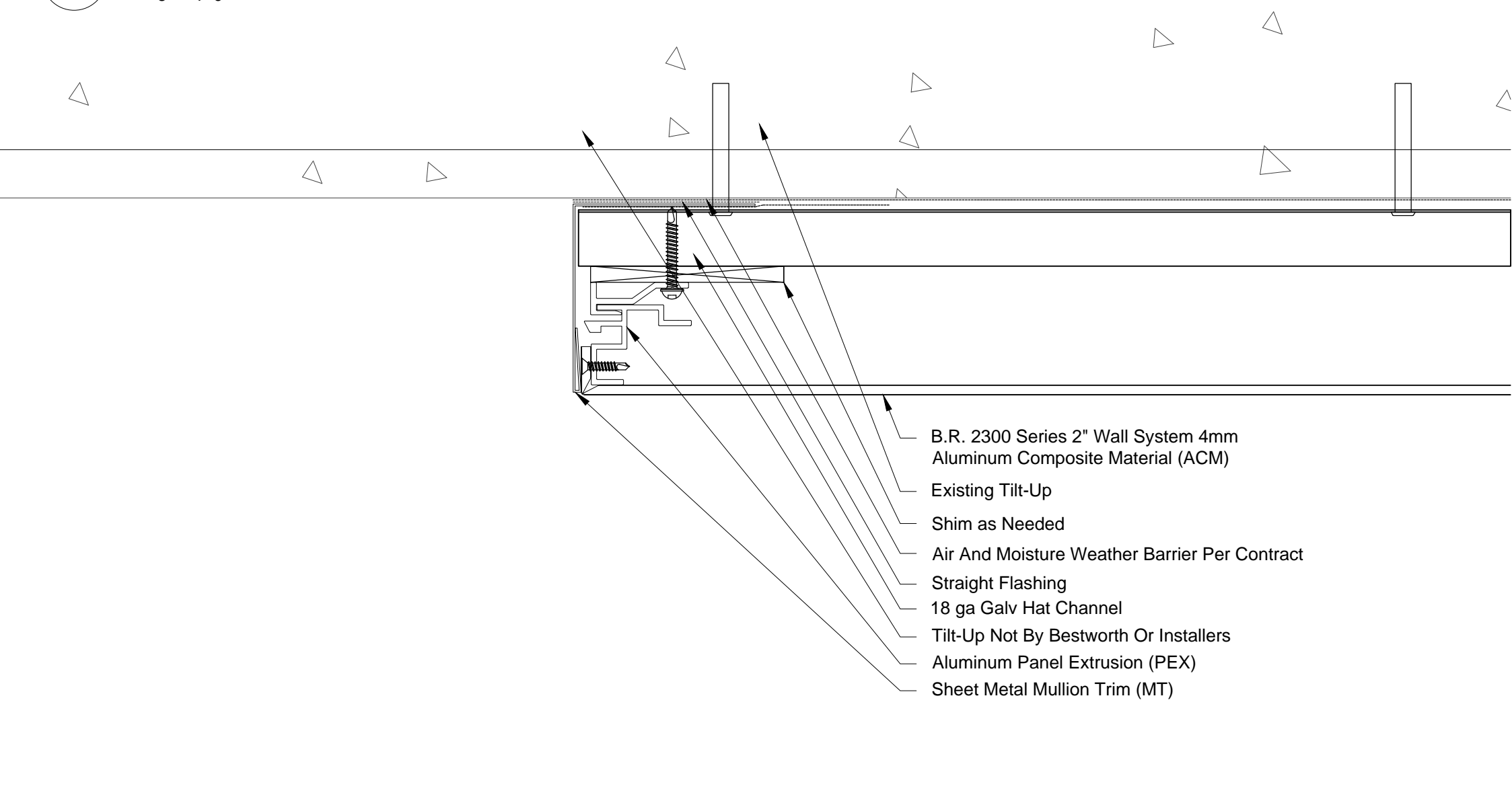

17 2300 ACM @ Termination - Tilt Up
6" = 1'-0"

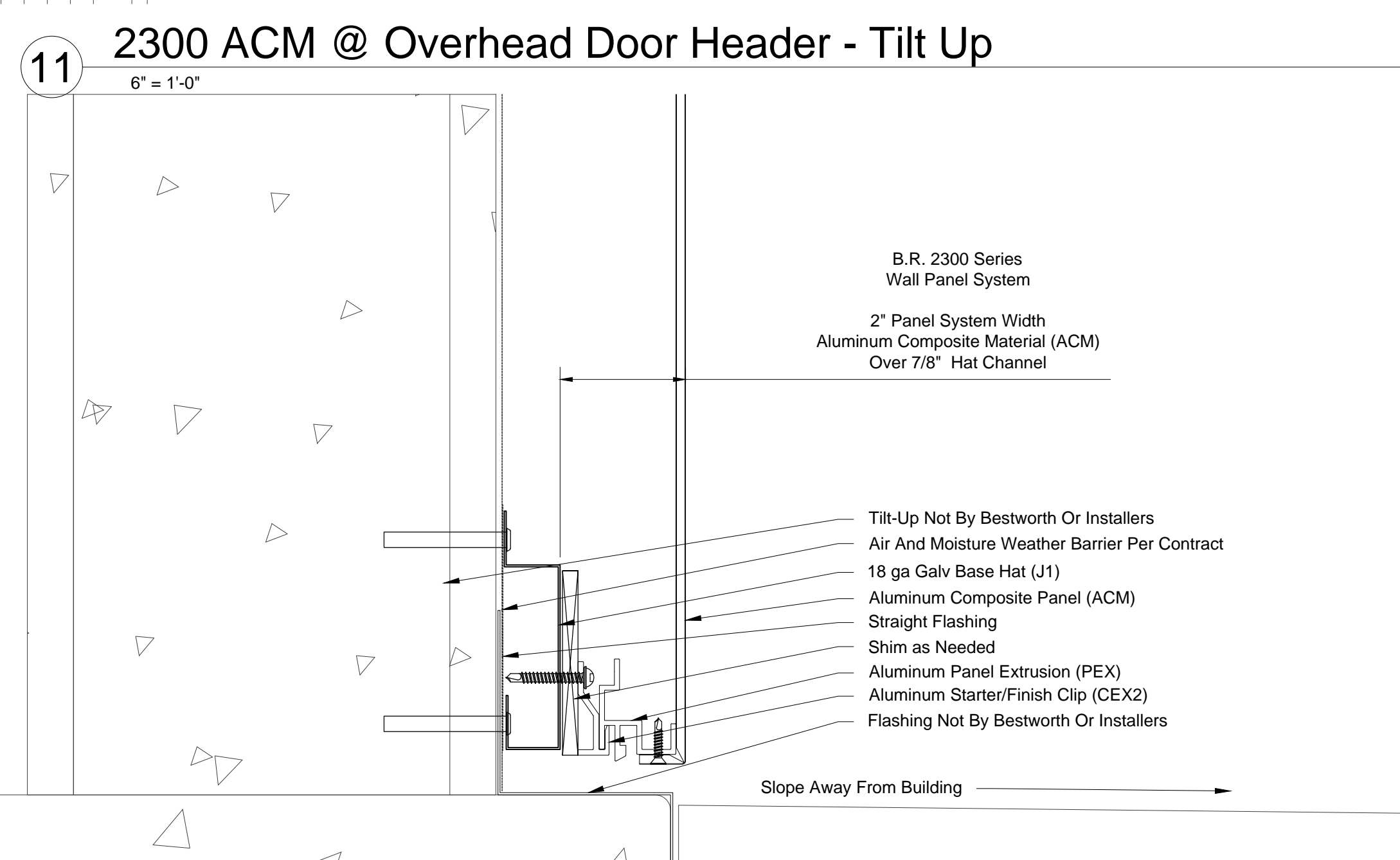

12 2300 ACM @ Base Condition - Tilt Up
6" = 1'-0"

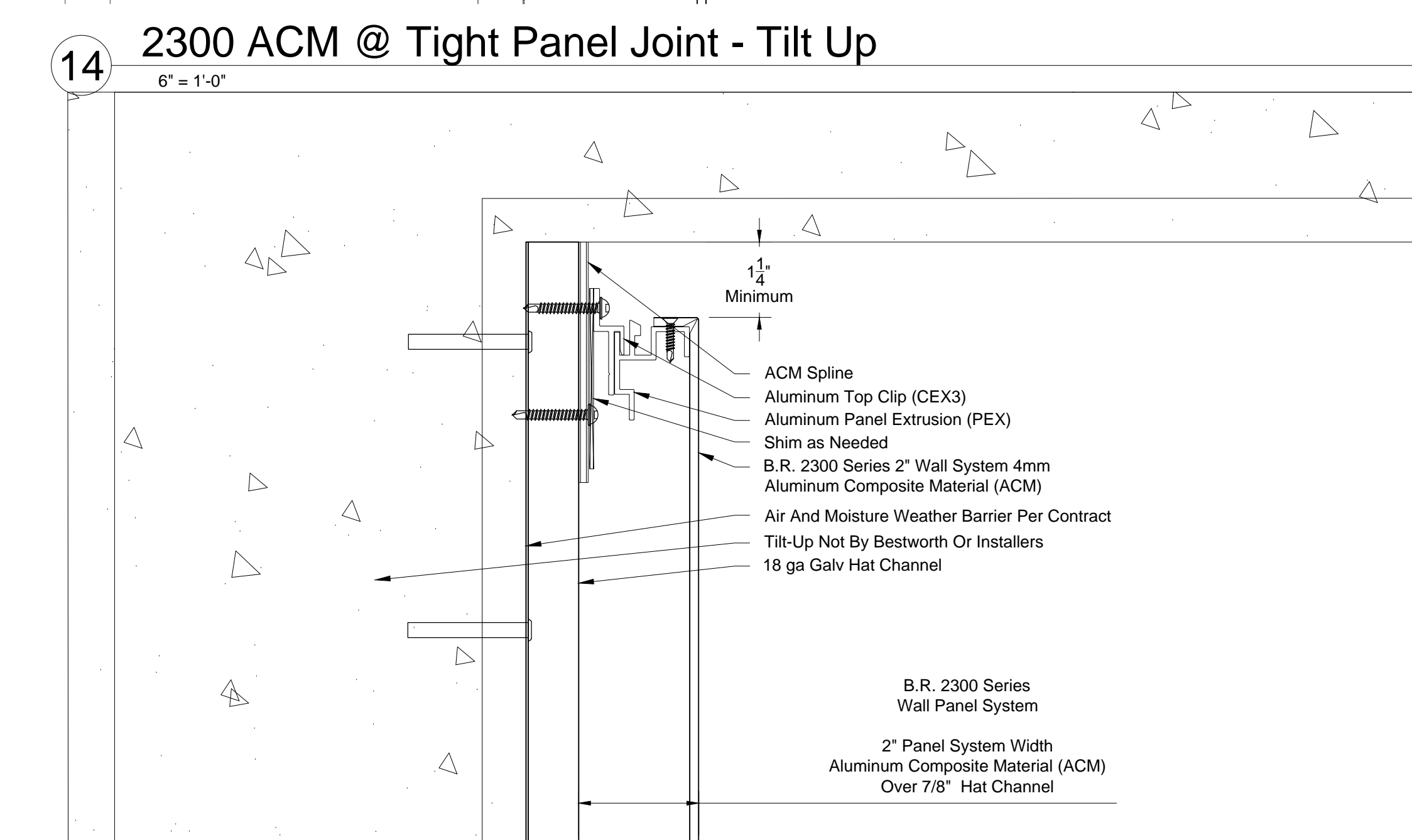

15 2300 ACM @ Soffit Termination - Tilt Up
6" = 1'-0"

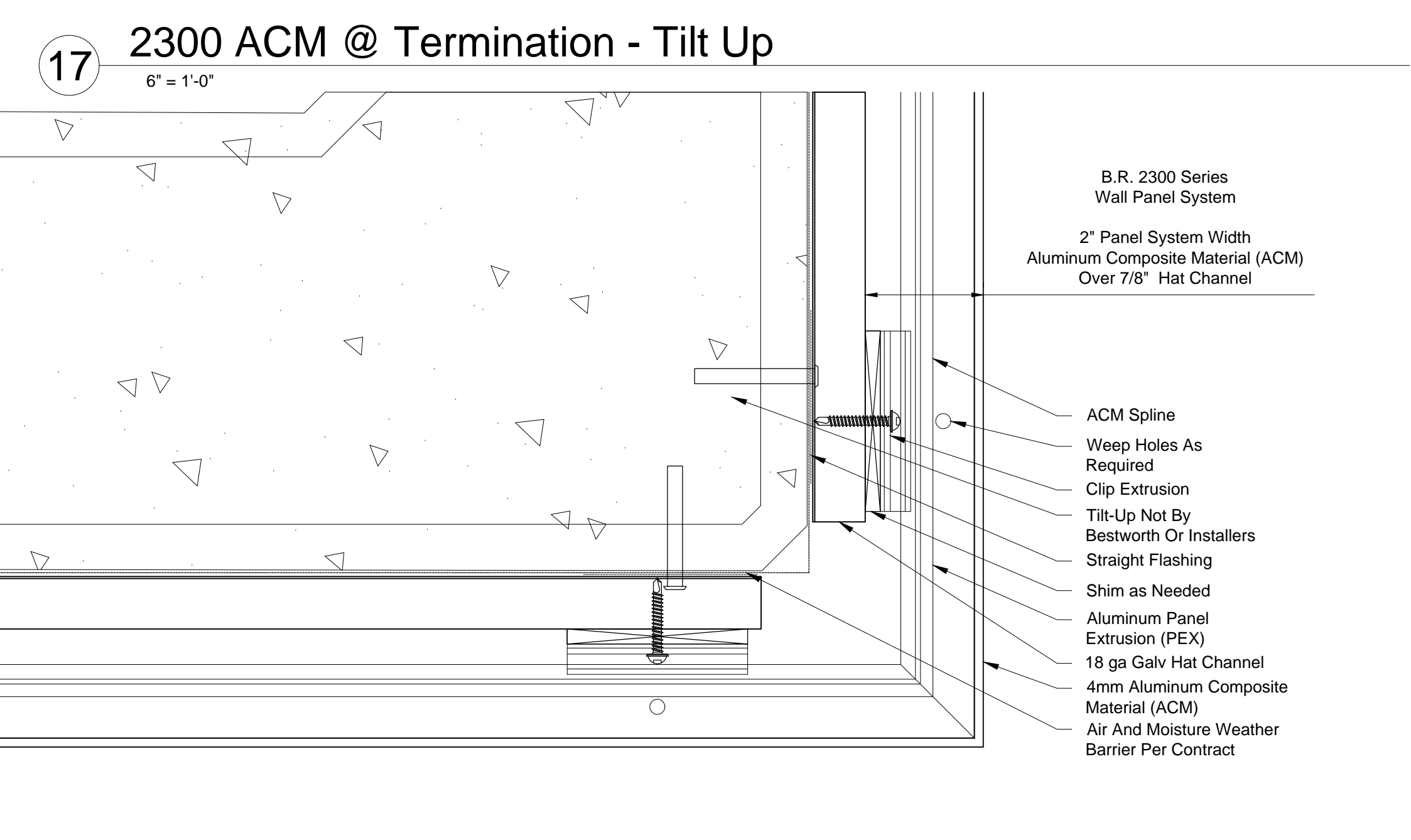

18 2300 ACM @ Outside Corner - Tilt Up
6" = 1'-0"

Standard 2300 ACM Tilt Up Framing Details

IF YOU ARE INTERESTED IN USING THESE DETAILS IN YOUR DESIGN SHEETS, PLEASE CONTACT BESTWORTHROMMEL FOR ADDITIONAL CAD DRAWINGS, OR FURTHER INFORMATION REGARDING OUR PANEL SYSTEMS.



BESTWORTHROMMEL
19818 74TH Ave. N.E.
Arlington, WA 98223
360.435.2927 PHONE - 360.435.3617 FAX
www.bestworth.com